

CABLE HARNESS chassis  
 KABELBAUM Fahrgestell  
 FAISCEAU DE CABLES chassis

from No / up to No  
 WFN5RUDP752029101  
 WFN5RUDP7#2029120

Figure  
 Bild 99707782092  
 Figure

**TADANO**  
 1700-05

PAGE 1 OF 11  
 SEITE 1 VON 11  
 PAGE 1 DE 11

1 ————— 2

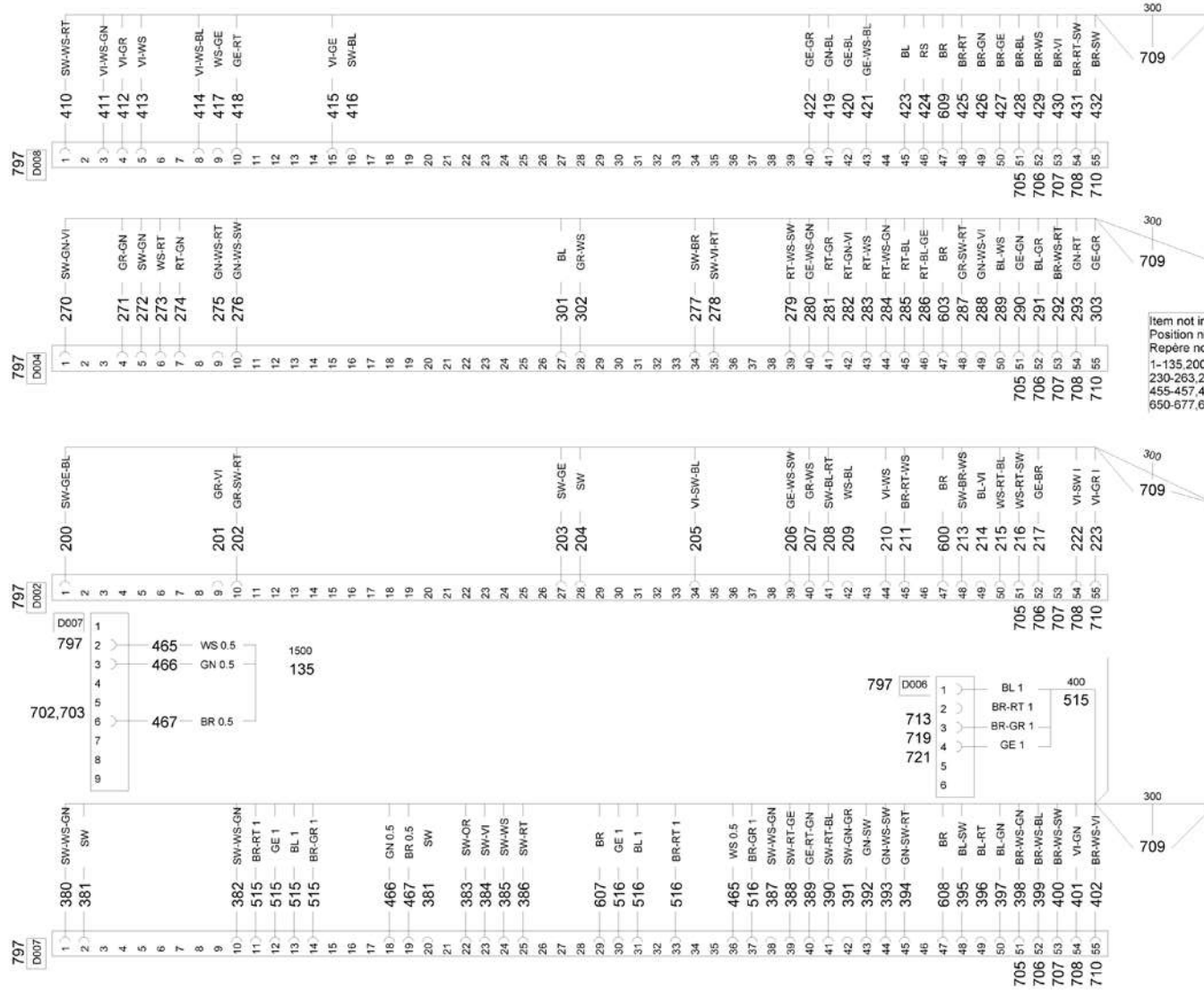

6 ————— 1

CABLE HARNESS chassis  
 KABELBAUM Fahrgestell  
 FAISCEAU DE CABLES chassis

from No / up to No  
 WFN5RUDP752029101  
 WFN5RUDP7#2029120

Figure  
 Bild 99707782092  
 Figure

**TADANO**  
 1700-05

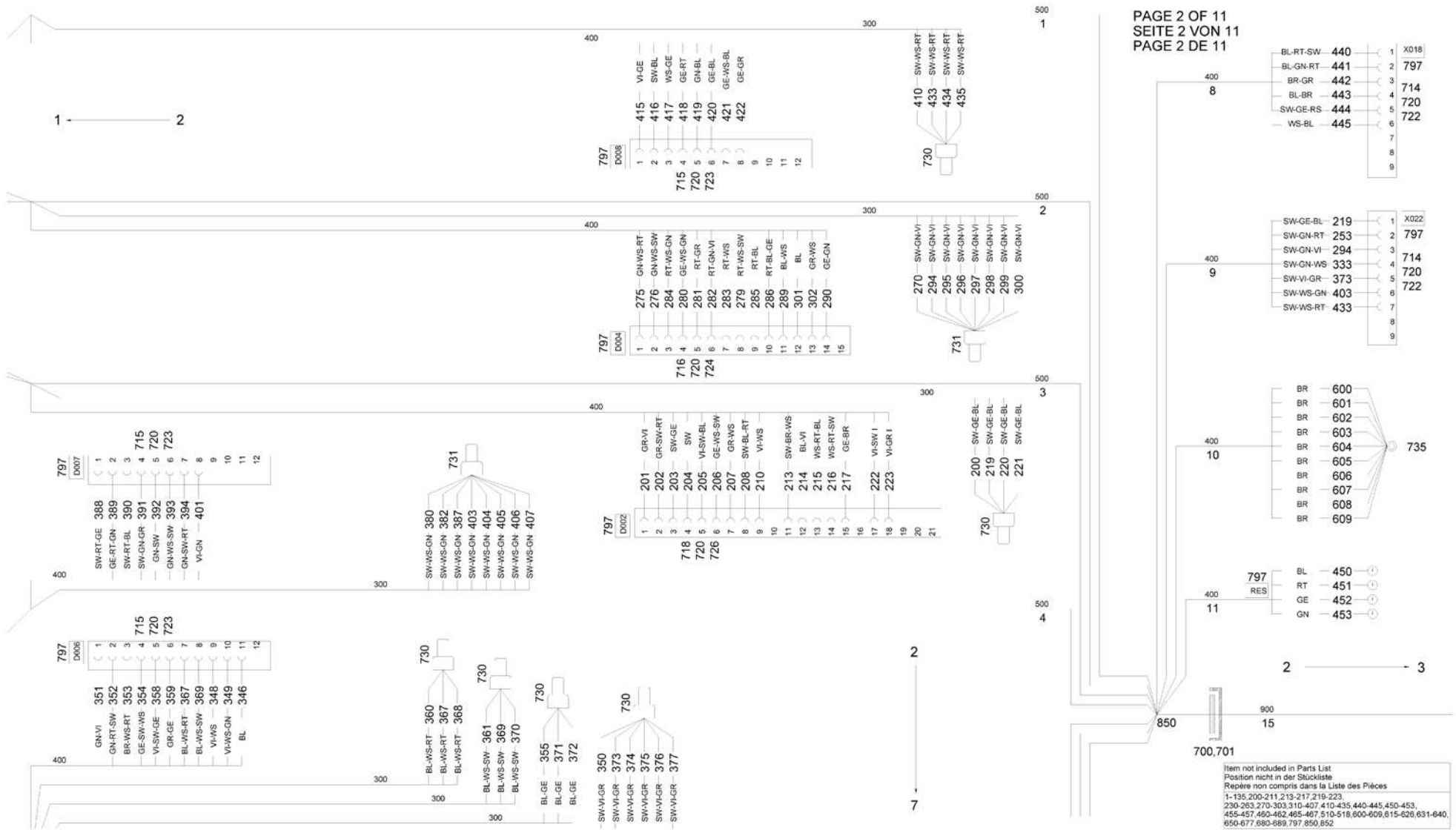

CABLE HARNESS chassis  
 KABELBAUM Fahrgestell  
 FAISCEAU DE CABLES chassis

from No / up to No  
 WFN5RUDP752029101  
 WFN5RUDP7#2029120

Figure  
 Bild 99707782092  
 Figure

**TADANO**  
 1700-05

PAGE 3 OF 11  
 SEITE 3 VON 11  
 PAGE 3 DE 11

Item not included in Parts List  
 Position nicht in der Stückliste  
 Repère non compris dans la Liste des Pièces  
 1-135,200-211,213-217,219-223,  
 230-263,270-303,310-407,410-435,440-445,450-453,  
 455-457,460-462,465-467,510-518,600-609,615-626,631-640,  
 650-677,680-689,797,850,852

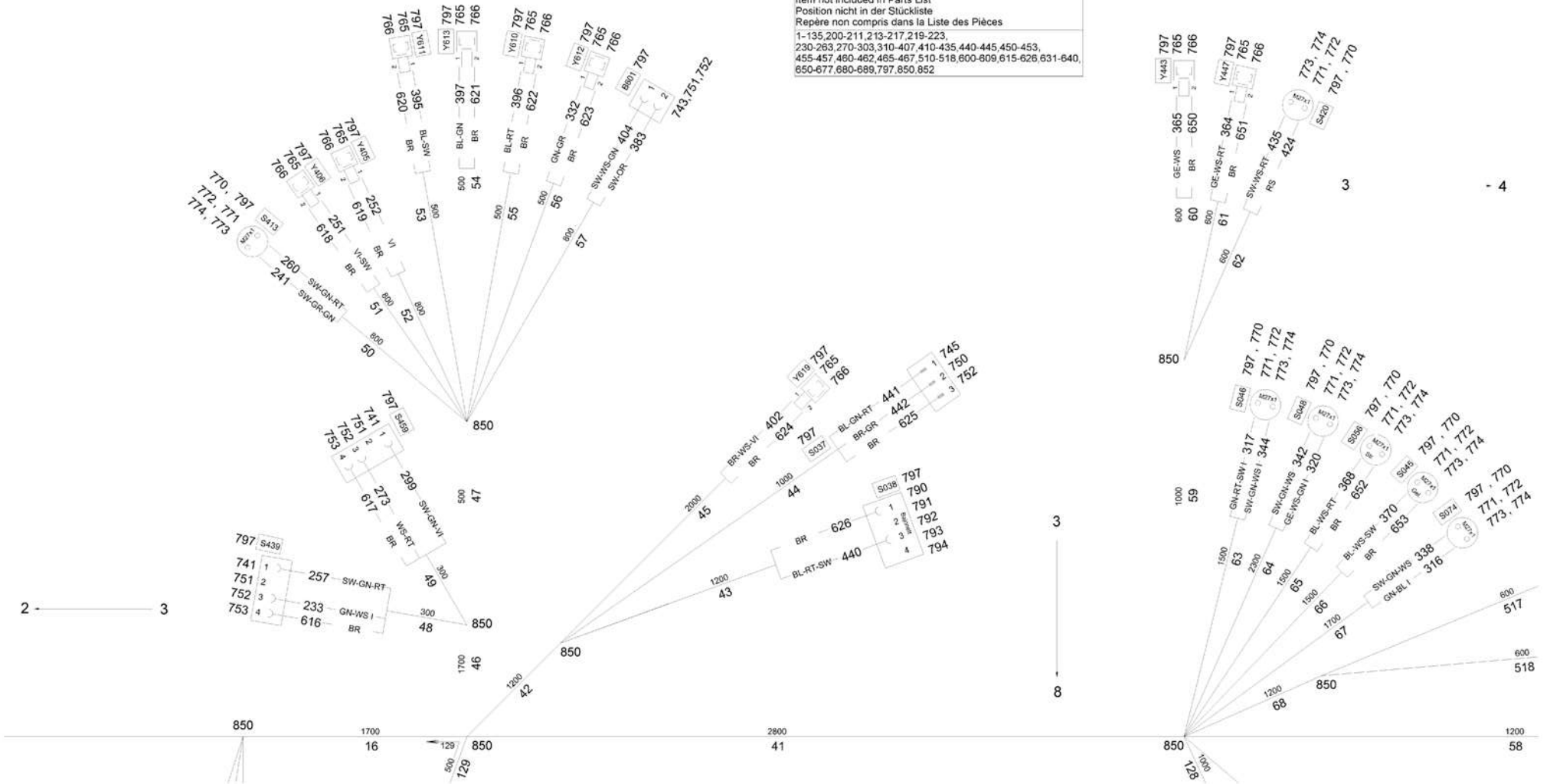

CABLE HARNESS chassis  
 KABELBAUM Fahrgestell  
 FAISCEAU DE CABLES chassis

from No / up to No  
 WFN5RUDP752029101  
 WFN5RUDP7#2029120

Figure  
 Bild 99707782092  
 Figure

**TADANO**  
 1700-05

PAGE 4 OF 11  
 SEITE 4 VON 11  
 PAGE 4 DE 11

Item not included in Parts List  
 Position nicht in der Stückliste  
 Repère non compris dans la Liste des Pièces  
 1-135 200-211, 213-217, 219-223,  
 230-263, 270-303, 310-407, 410-435, 440-445, 450-453,  
 455-457, 460-462, 465-467, 510-518, 600-609, 615-626, 631-640,  
 650-677, 680-689, 797, 850, 852

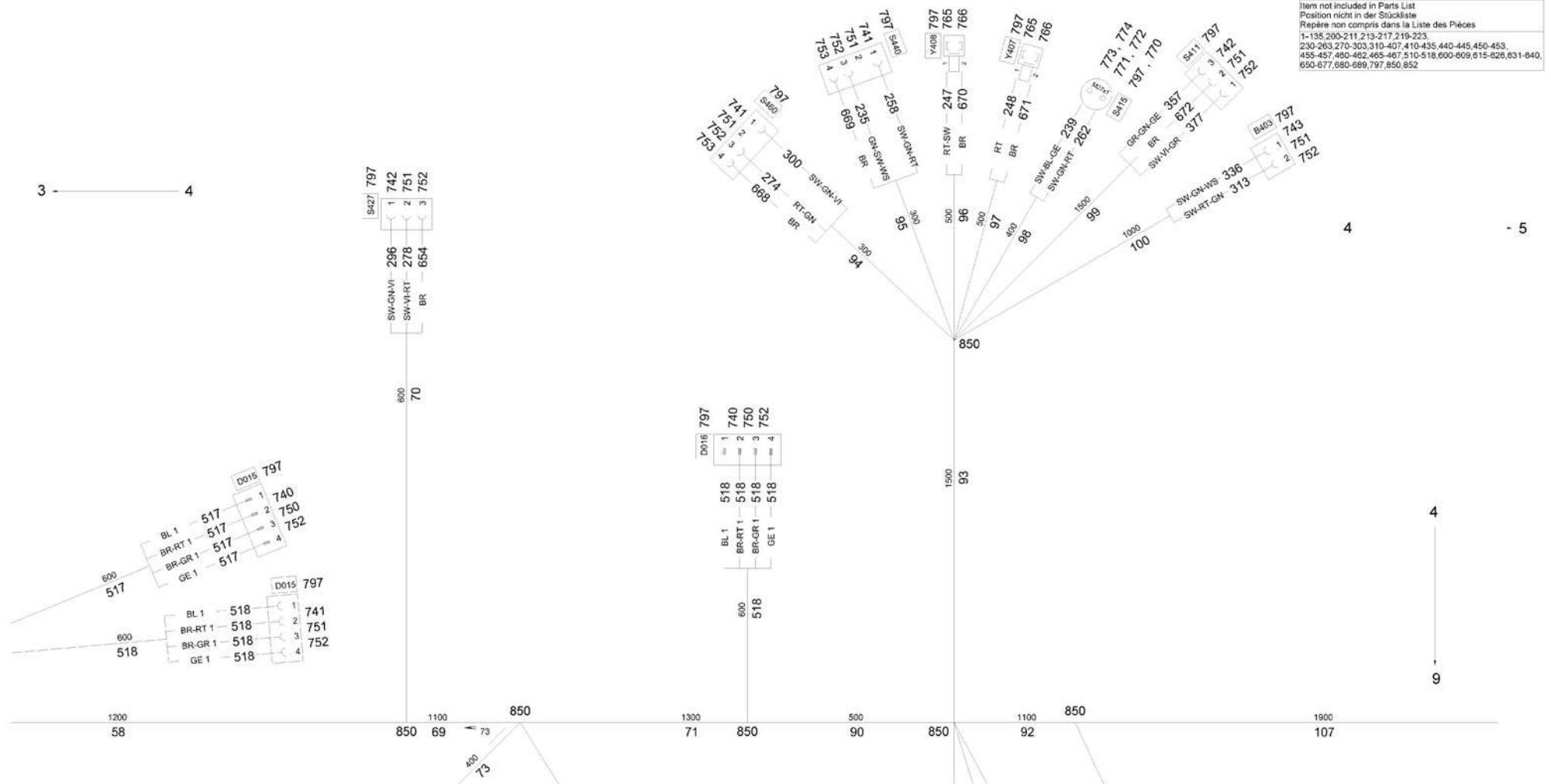

CABLE HARNESS chassis  
KABELBAUM Fahrgestell  
FAISCEAU DE CABLES chassis

from No / up to No  
WFN5RUDP752029101  
WFN5RUDP7#2029120

Figure  
Bild 99707782092  
Figure

**TADANO**  
1700-05

PAGE 5 OF 11  
SEITE 5 VON 11  
PAGE 5 DE 11

Item not included in Parts List  
Position nicht in der Stückliste  
Repère non compris dans la Liste des Pièces  
1-135,200-211,213-217,219-223,  
230-263,270-303,310-407,410-435,440-445,450-453,  
455-457,460-462,465-467,510-518,600-609,615-626,631-640,  
650-677,680-689,797,850,852

4 ————— 5

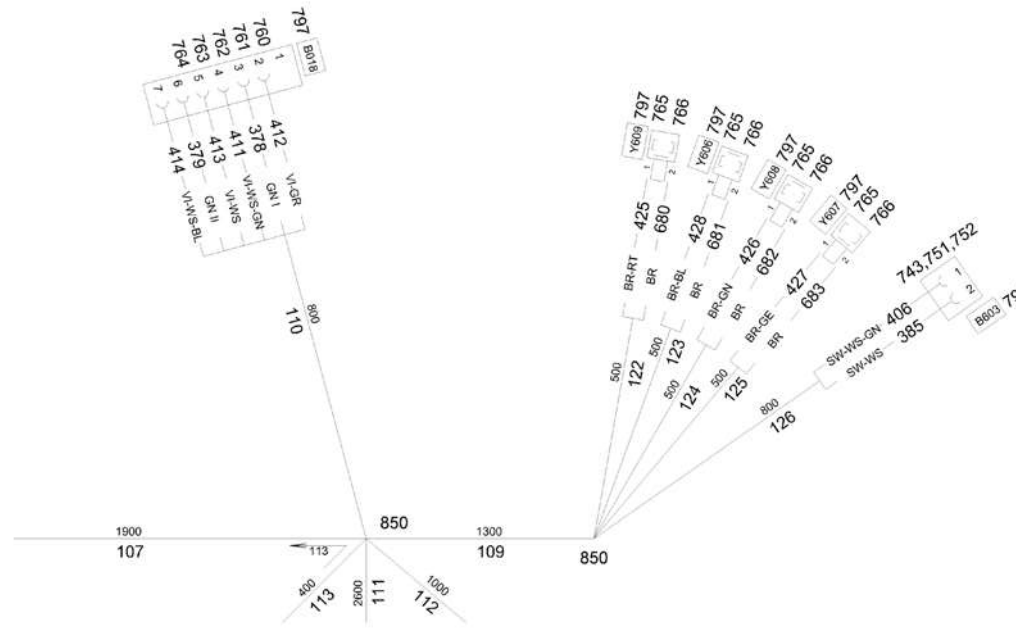

1  
 ↑  
 6

Item not included in Parts List  
 Position nicht in der Stückliste  
 Repère non compris dans la Liste des Pièces  
 1-135,200-211,213-217,219-223,  
 230-283,270-303,310-407,410-435,440-445,450-453,  
 455-457,480-482,485-467,510-518,600-609,615-626,631-640,  
 650-677,680-689,797,850,852

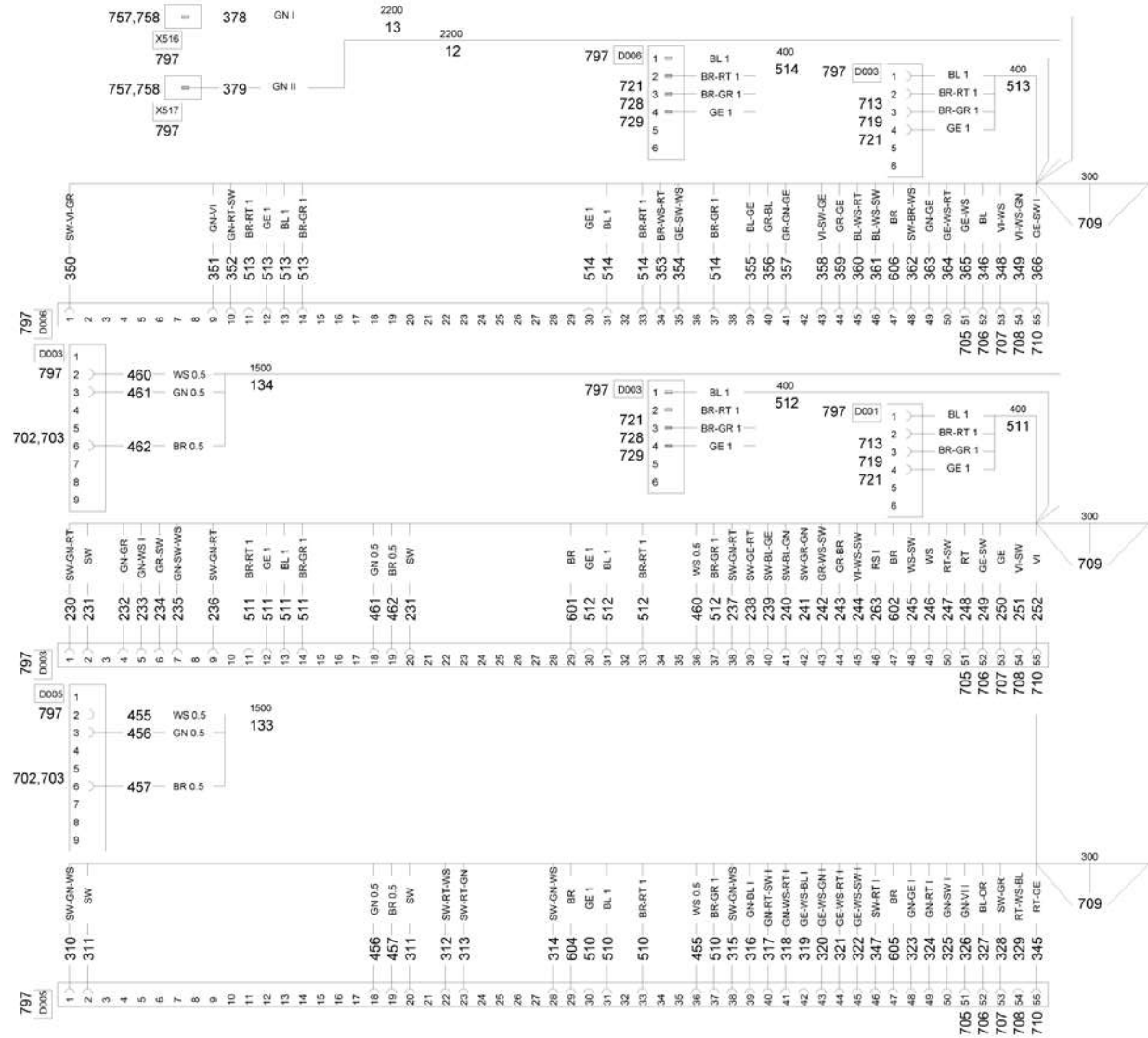

6 ——— 7

CABLE HARNESS chassis  
 KABELBAUM Fahrgestell  
 FAISCEAU DE CABLES chassis

from No / up to No  
 WFN5RUDP752029101  
 WFN5RUDP7#2029120

Figure  
 Bild 99707782092  
 Figure

**TADANO**  
 1700-05



PAGE 7 OF 11  
 SEITE 7 VON 11  
 PAGE 7 DE 11





CABLE HARNESS chassis  
KABELBAUM Fahrgestell  
FAISCEAU DE CABLES chassis

from No / up to No  
WFN5RUDP752029101  
WFN5RUDP7#2029120

Figure  
Bild 99707782092  
Figure

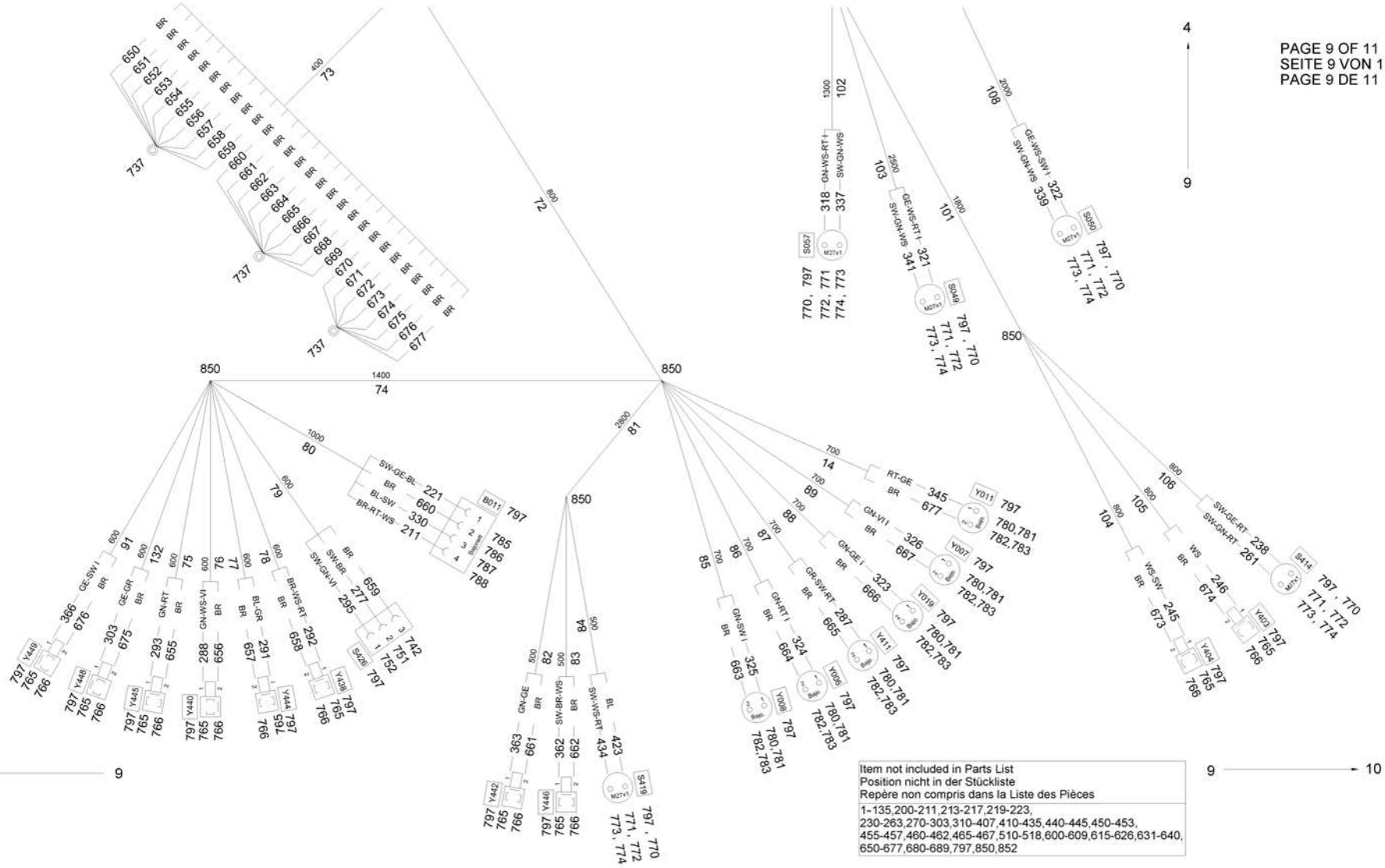

PAGE 9 OF 11  
SEITE 9 VON 11  
PAGE 9 DE 11

CABLE HARNESS chassis  
 KABELBAUM Fahrgestell  
 FAISCEAU DE CABLES chassis

from No / up to No  
 WFN5RUDP752029101  
 WFN5RUDP7#2029120

Figure  
 Bild 99707782092  
 Figure

**TADANO**  
 1700-05

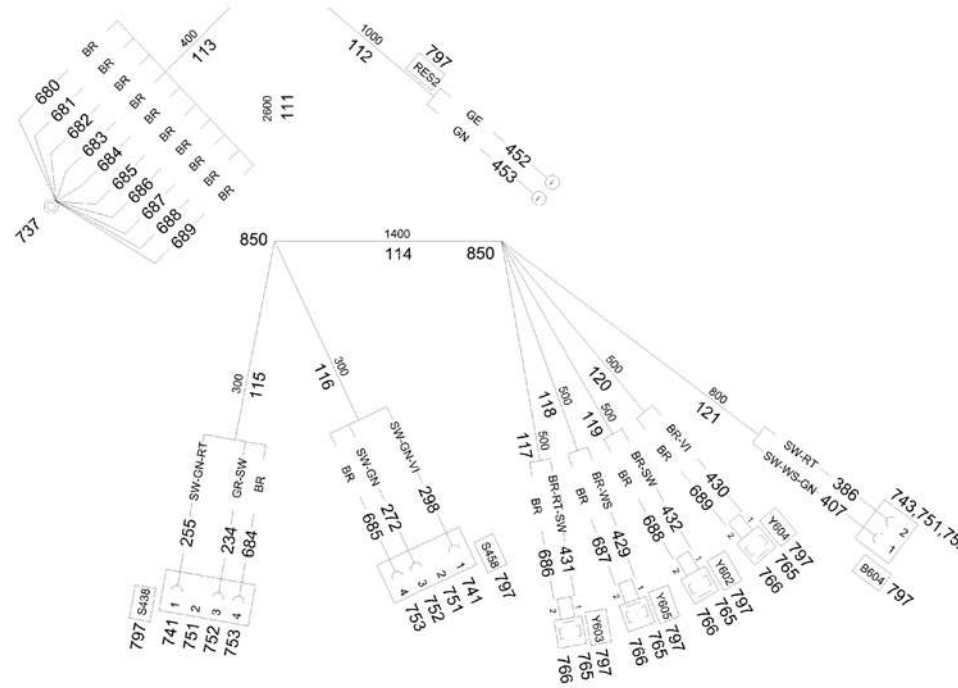

PAGE 10 OF 11  
 SEITE 10 VON 11  
 PAGE 10 DE 11

5  
 10

Item not included in Parts List  
 Position nicht in der Stückliste  
 Repère non compris dans la Liste des Pièces  
 1-135,200-211,213-217,219-223,  
 230-263,270-303,310-407,410-435,440-445,450-453,  
 455-457,460-462,465-467,510-518,600-609,615-626,631-640,  
 650-677,680-689,797,850,852

CABLE HARNESS chassis  
KABELBAUM Fahrgestell  
FAISCEAU DE CABLES chassis

from No / up to No  
WFN5RUDP752029101  
WFN5RUDP7#2029120

Figure  
Bild 99707782092  
Figure

**TADANO**  
1700-05

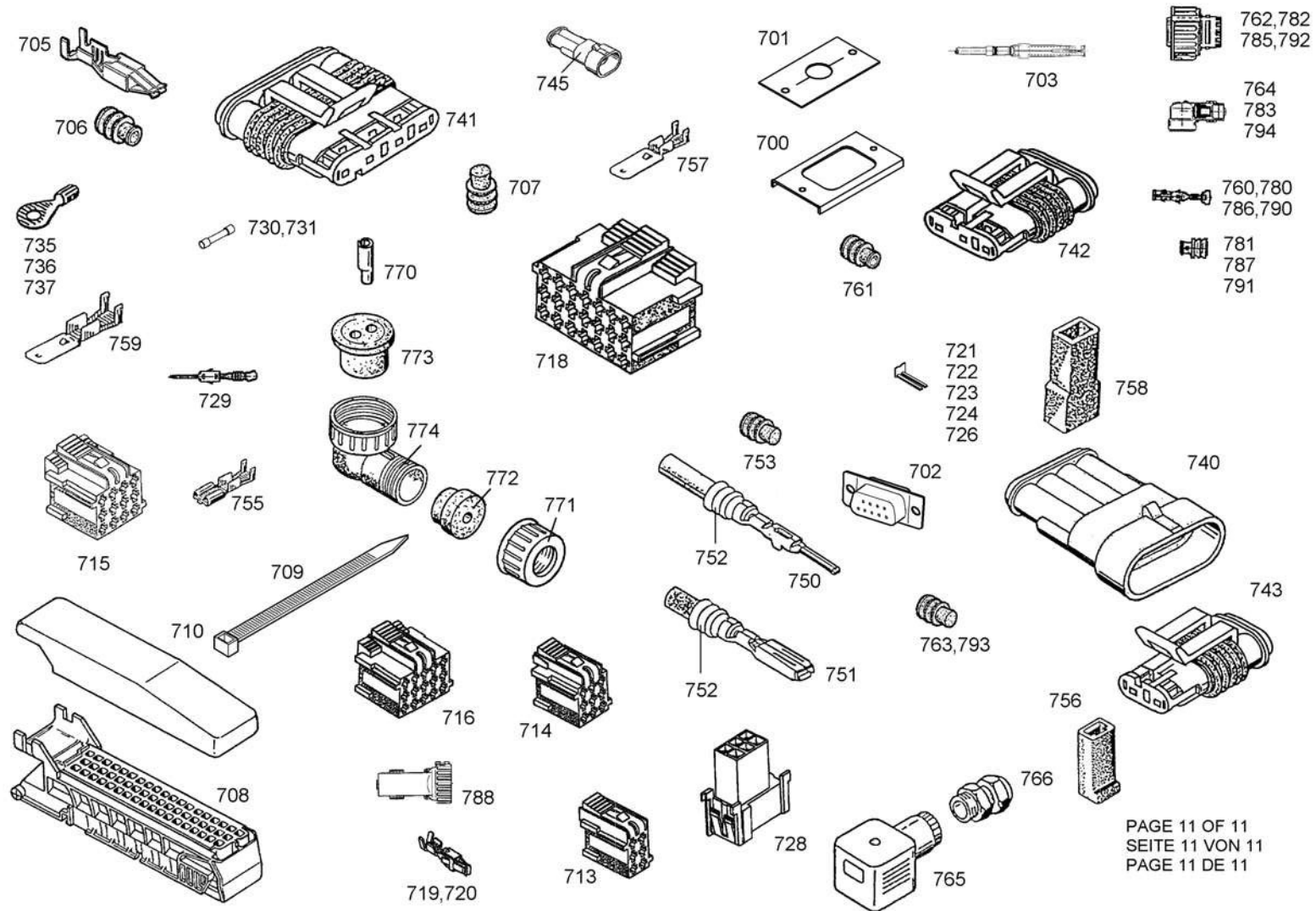

PAGE 11 OF 11  
SEITE 11 VON 11  
PAGE 11 DE 11